

SET-OUT POINT

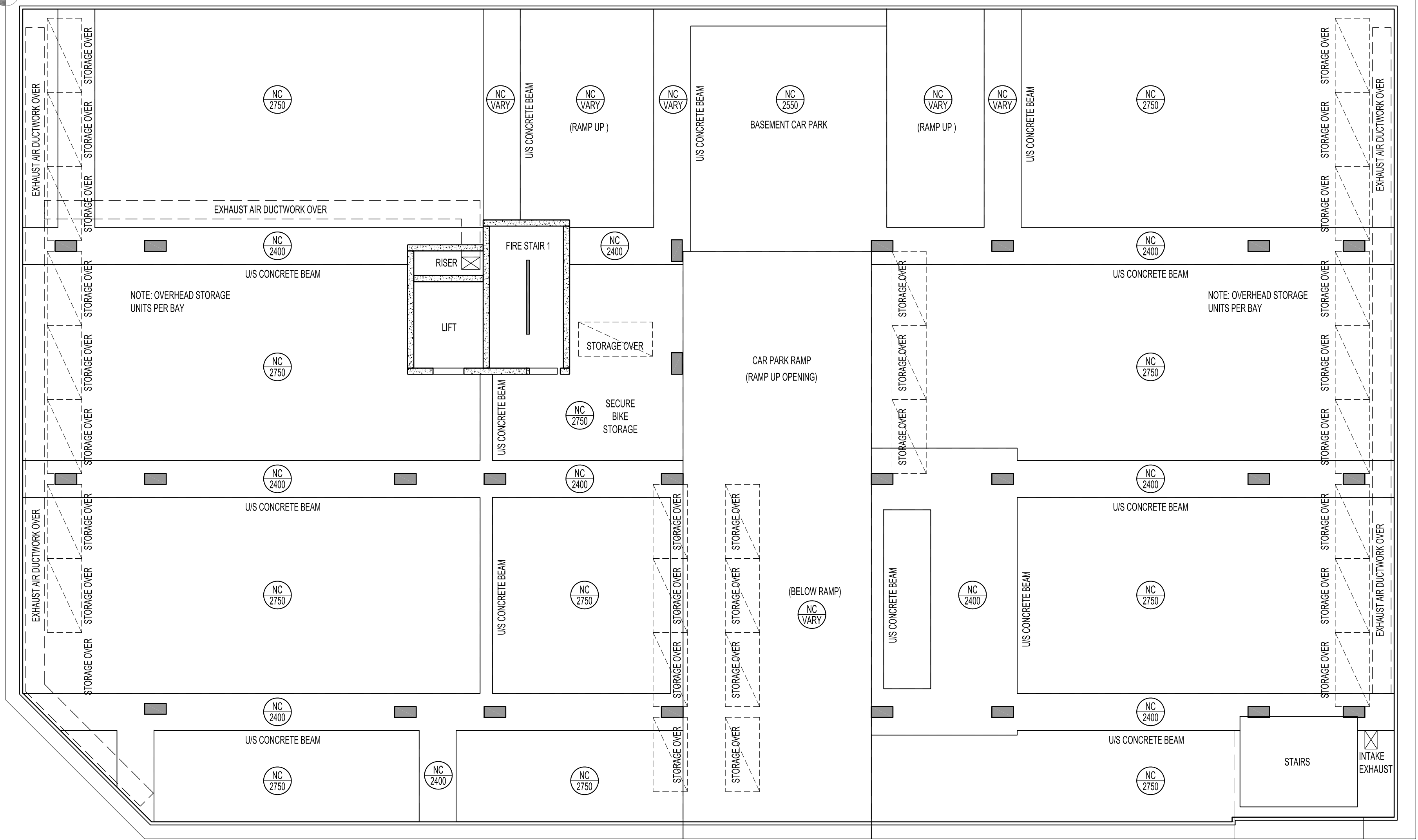

BASEMENT REFLECTED CEILING PLAN  
SCALE 1:100

CEILING SCHEDULE

X  
Y  
DENOTES CEILING TYPE  
DENOTES CEILING HEIGHT ABOVE FFL

LEGEND

FPB DENOTES 10mm THICK FLUSH PLASTERBOARD LINING  
FC DENOTES 6mm FIBRE CEMENT LINING  
NC DENOTES NO CEILING  
VARY DENOTES VARYING CEILING LEVEL  
BH BULKHEAD IN CEILING - 10mm FLUSH PLASTERBOARD LINING  
T TIMBER BATTEN AT 20mm SPACED ON PAINTED 6mm FIBRE CEMENT LINING  
C CONCRETE UNDERSIDE

NatHERS ASSESSMENT

REFER TO THE ENGINEERS NatHERS ASSESSMENT REPORT FOR THE THERMAL INSULATION & GLAZING REQUIREMENTS .

ACOUSTIC NOTE

REFER TO THE VIPAC ENGINEERS ACOUSTIC ASSESSMENT REPORT FOR THE REQUIRED NOISE LIMITS .

IN ADDITION, REFER TO COUNCIL PLANNING CONDITION 16 FOR GLAZING ACOUSTIC;  
- 8mm LAMINATED GLAZING FOR GROUND FLOOR TENANCIES  
- 8mm LAMINATED GLAZING/10mm GAP/ 6mm GLAZING FOR BEDROOMS FACING PROSPECT ROAD

A	18.03.18	FOR CONSTRUCTION	DP
REV	DATE	COMMENT	DRN



CITIFY

FERRONE

WEB: WWW.FERRONE.COM.AU  
E-MAIL: ARCHITECT@FERRONE.COM.AU  
POSTAL ADDRESS: P.O. BOX 3414, RUNDLE MALL, ADELAIDE, SA, 5000  
BUSINESS ADDRESS: LEVEL 2, 93 RUNDLE MALL, ADELAIDE, SA, 5000  
ALL RIGHTS RESERVED. THESE DRAWINGS REMAIN THE INTELLECTUAL PROPERTY OF FERRONE ARCHITECTS PTY LTD. ANY REPRODUCTION OF WHOLE OR PART THEREOF IS STRICTLY PROHIBITED WITHOUT PRIOR CONSENT. ALL DRAWINGS ARE CONCEPTUAL ONLY AND ARE SUBJECT TO CHANGE WITHOUT NOTICE. DIMENSIONS AND AREAS ARE APPROXIMATE AND MAY VARY OR DIFFER WITH ACTUAL CONSTRUCTION.  
© 2017 FERRONE ARCHITECTS PTY LTD

FOR CONSTRUCTION

CLIENT: CITIFY & BFC PTY LTD  
ADDRESS: 117 PROSPECT ROAD  
PROSPECT SA 5082  
PROJECT: THE WILLCOX APARTMENTS

SHEET TITLE: REFLECTED CEILING PLAN  
BASEMENT

JOB REF: 18.CITI  
DRAWN: DF  
SCALE: 1:100  
DRAWING NO. WD.500  
DATE: MARCH 2018  
CHECKED: DF  
PAPER: A1  
REVISION: A

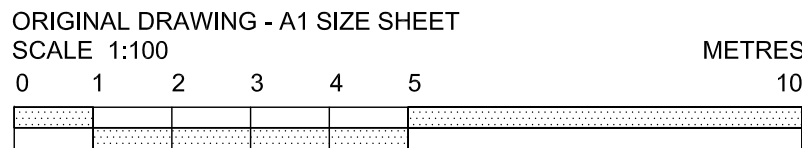
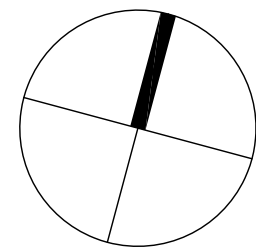

ALL EXHAUST FANS TO BE VENTED TO THE OUTSIDE

SITWORKS, DRAINAGE AND LEVELS TO BE AS PER ENGINEERS DESIGN AND DETAIL

BUILDER TO CHECK AND CONFIRM ALL DIMENSIONS PRIOR TO COMMENCEMENT OF CONSTRUCTION